



INSTALLATION INSTRUCTIONS

Accessory

SPLASH GUARDS
P/N 08P00-S6M-200

Application

2003 RSX

Publications No.

BII 24463

Issue Date

SEP 2002

PARTS LIST

Right front splash guard

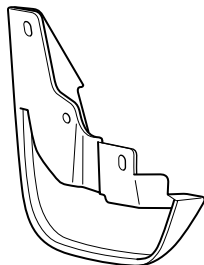

Left front splash guard

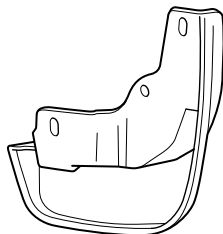

Right rear splash guard

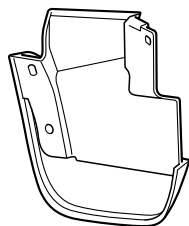

Left rear splash guard

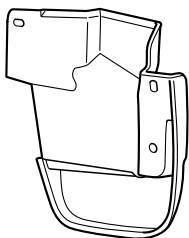

6 Self-tapping screws

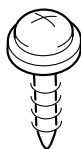

4 Spring nuts



TOOLS REQUIRED

Stubby Phillips screwdriver

INSTALLATION

NOTE:

- These instructions are for the left side of the vehicle. The same procedure applies to the right side of the vehicle.
- Clean the area to be covered, and wax it with a high-quality paste wax.

Installing the Front Splash Guards

1. Turn the steering wheel all the way counterclockwise.
2. Remove the three self-tapping screws that fasten the inner fender.

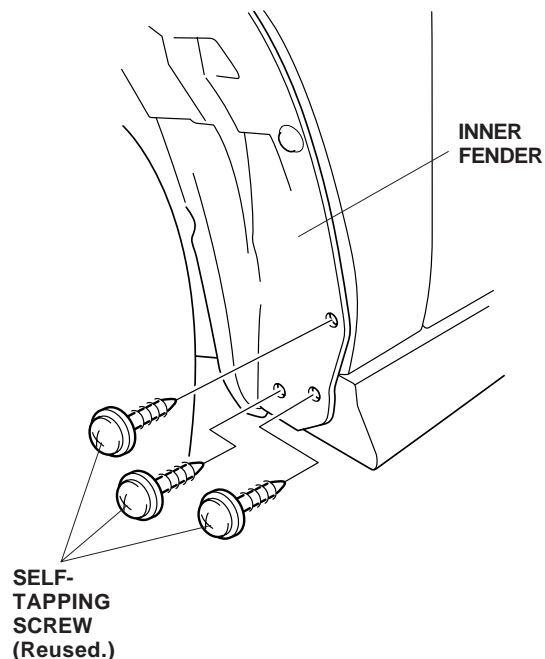

3. Position the front splash guard on the inner fender, and reinstall the three self-tapping screws.

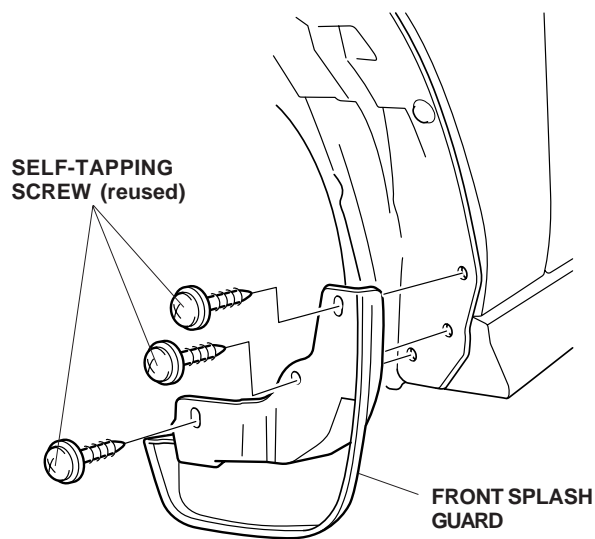

4. Turn the steering all the way clockwise and repeat steps 2 and 3 to install the right front splash guard.

Installing the Rear Splash Guards

5. Remove the self-tapping screw from the rear inner fender, and two self-tapping screws from the rear bumper, then remove the cover.

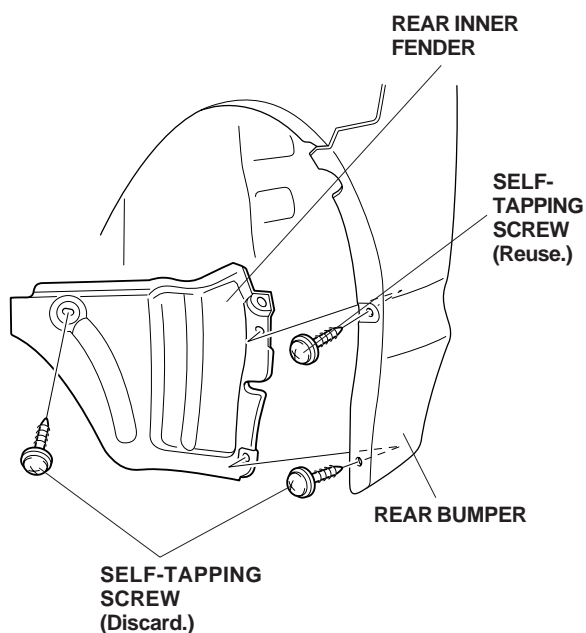

6. Slide spring nuts over the dimpled area and the lower hole of the rear bumper.

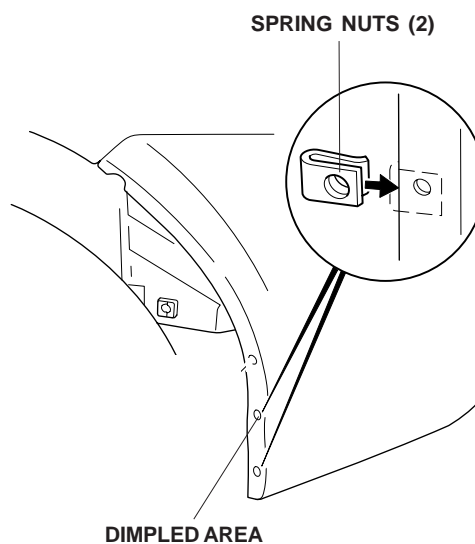

7. Position the rear splash guard on the rear bumper and fenderwell, and install three self-tapping screws.

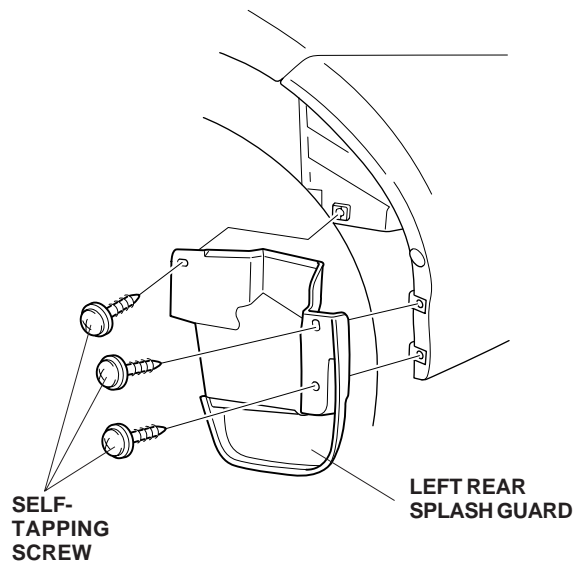

9. Repeat steps 5 through 7 to install the right rear splash guard.